



# LIFE SAFETY TRAFFIC CIRCULATION PLAN WITH EXISTING FIRE HYDRANT LOCATIONS

CITY OF POMPANO BEACH'S SENIOR  
ACTIVITY CENTER OVERFLOW PARKING LOT

Phase:  
RC No.2  
DOCUMENTS

Scale: 1"=20'	
Job No. 2023-1500	Sheet No. <b>LS1</b>
Date 02/14/2023	
Drawn by SM	Plot Date 10/23/20
Appr. by HG	1 of 1

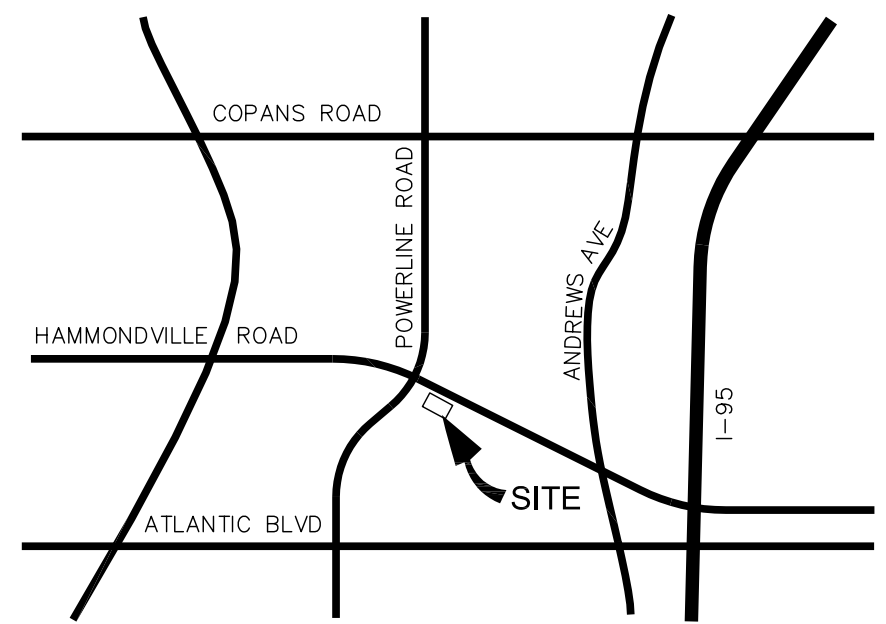

LOCATION SKETCH NTS

LEGEND:

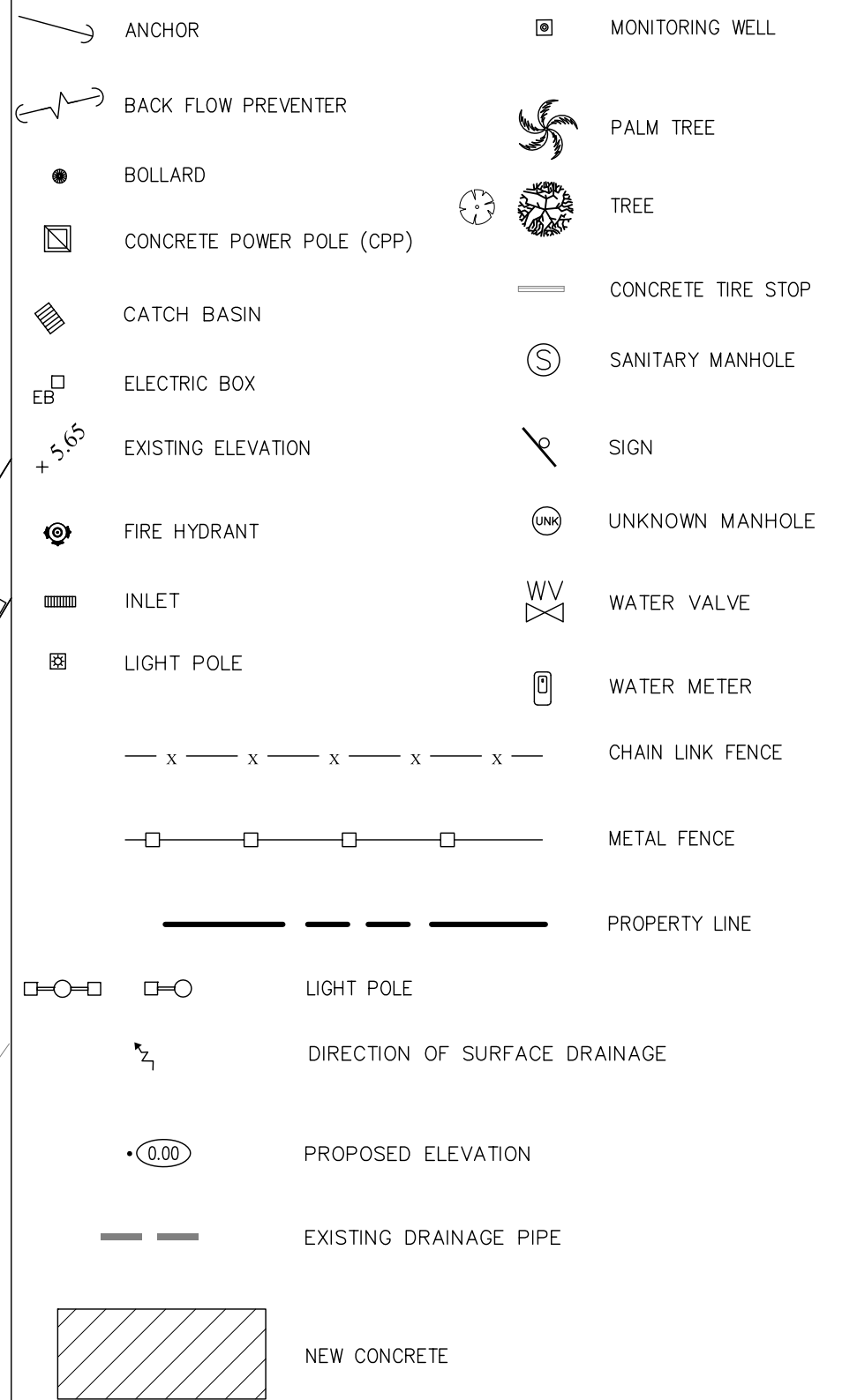

LEGAL DESCRIPTION:

A PORTION OF PARCEL A, AS SHOWN ON THE PLAT OF "RENTERIA INC., PLAT", ACCORDING TO THE PLAT THEREOF, AS RECORDED IN PLAT BOOK 166, PAGE 33, OF THE PUBLIC RECORDS OF BROWARD COUNTY, FLORIDA.

SAID LANDS LYING AND BEING IN THE CITY OF POMPANO BEACH, BROWARD COUNTY, FLORIDA.

Digitally signed by  
Shane Munson  
DN: c=US,  
o=Munson Design  
and Consulting  
Inc,  
dnQualifier=A0141  
0C00000188DFD1  
1E920000B0C8,  
cn=Shane Munson  
Date: 2023.10.25  
14:38:44 -04'00'

DATE: 10/23/2023

PRINTED COPIES OF THIS DOCUMENT ARE NOT CONSIDERED SIGNED AND SEALED  
AND THE SIGNATURE MUST BE VERIFIED ON ANY ELECTRONIC COPIES.

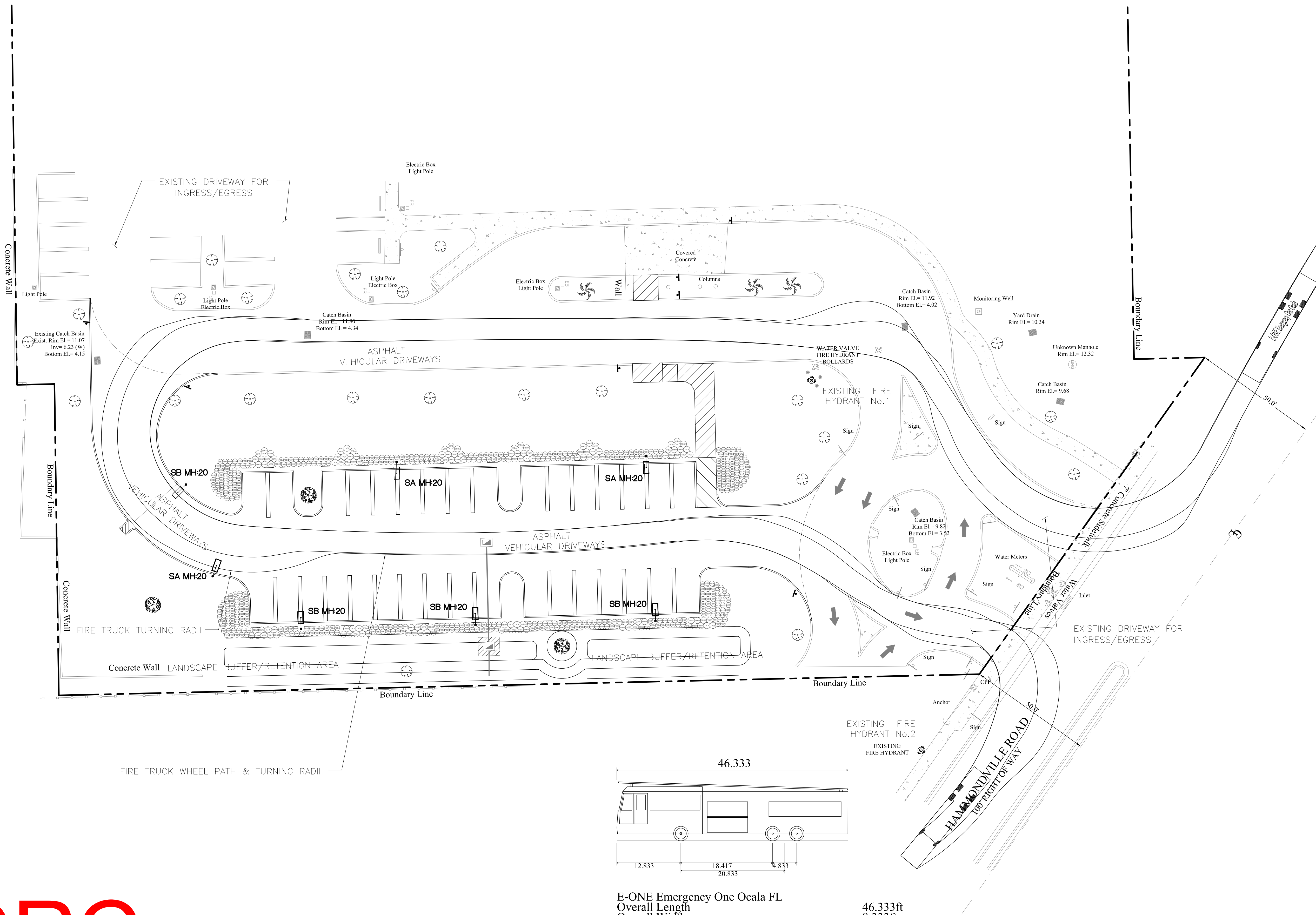
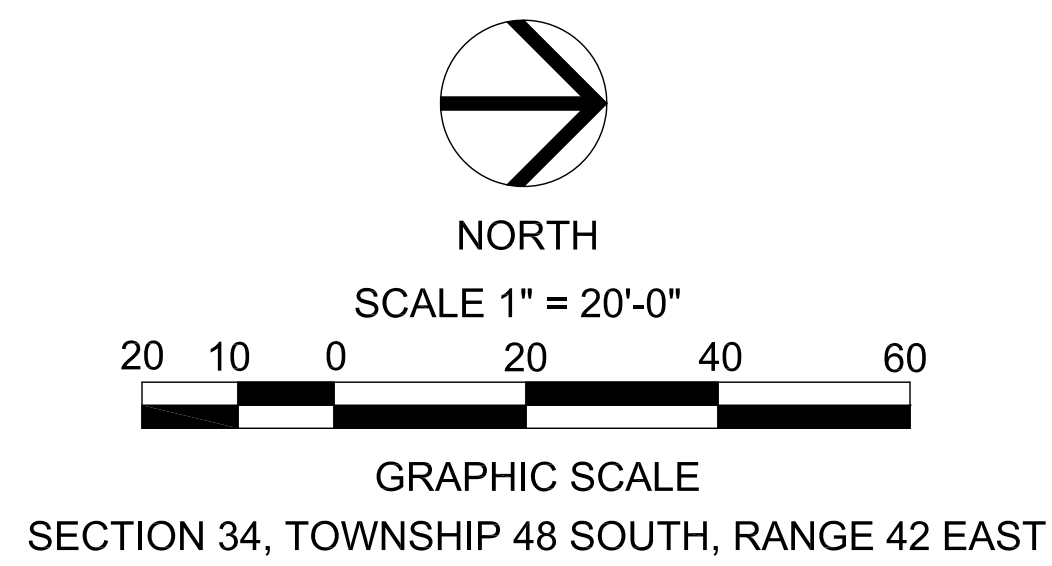

E-ONE Emergency One Ocala FL  
Overall Length  
Overall Width  
Overall Body Height  
Min Body Ground Clearance  
Track Width  
Lock-to-lock time  
Max Wheel Angle

46.333ft  
8.333ft  
11.833ft  
1.393ft  
8.333ft  
6.00s  
45.00°

**DRC**  
PZ23-12000015  
12/06/2023